



# M/Y SEATALY

Seataly features a white superstructure, striking lines and can cruise up to 24 knots. Her interiors have a cool and contemporary feel with classic beige soft furnishings and a pop of color to complement the vintage teak floors.

Seataly is a very eco-friendly yacht making use of recycled vintage wood flooring and engines designed for reduced emissions. Her vintage regenerated teak is made out of recycled boards, typically used in Javanese houses 100 to 150 years ago. Seataly's interior configuration has been designed to comfortably accommodate up to 10 guests in 5 double cabins.



LENGTH

BEAM

DRAFT

MAX SPEED

29.6m

7m

2m

26kn



GUESTS/CABINS

NUMBER OF CREW

SHIPYARD

YEAR BUILT

10/5

4

Amer

2016



WEEKLY CHARTER RATE

From 60,000€



Upper Deck

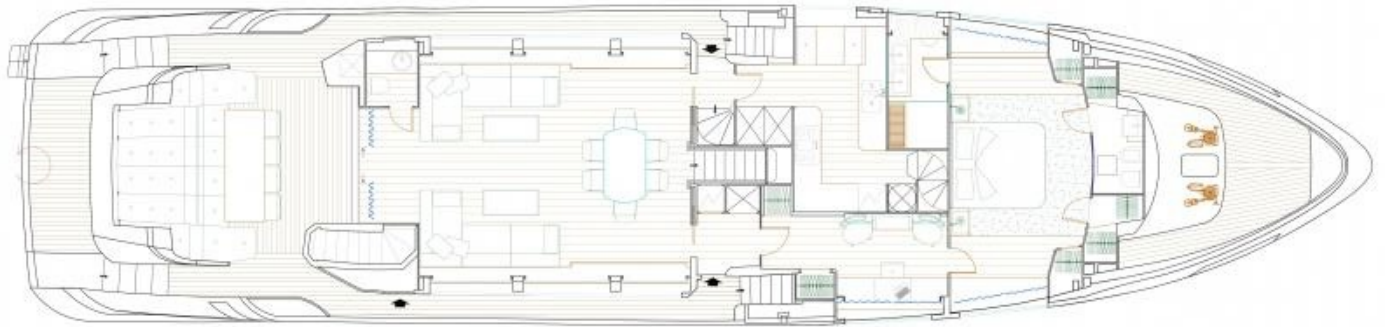

Main Deck

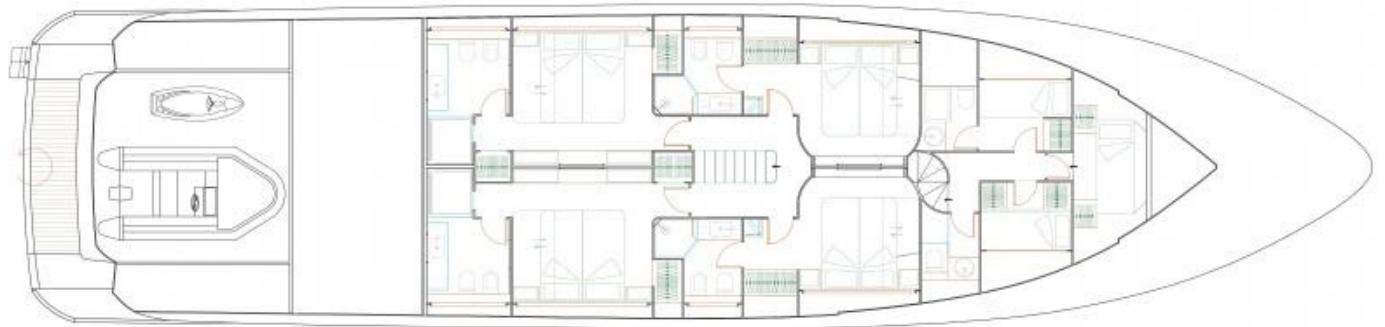

Lower Deck

























































#### FIND US

45 rue Grimaldi  
98000 Monaco

[Info@dynamiqbrokerage.com](mailto:Info@dynamiqbrokerage.com)

© 2024 DYNAMIQ YACHTS, SARL. All rights reserved.