



M/Y ELIXIR

One of the most exciting boats delivered in 2016, award-winning ELIXIR is a stunning 55m motor yacht. Built by Amels, she features northern European pedigree as a limited-edition yacht from the Dutch shipyard's renowned 180 range. Combining stability and seaworthiness with vast deck spaces and fabulous interiors, ELIXIR offers guests an enhanced charter experience.

With 5 generously-sized and well-appointed staterooms plus a flexible layout, ELIXIR can welcome up to 12 guests onboard overnight.



LENGTH

55m



BEAM

9.4m



DRAFT

3.35m



MAX SPEED

16kn



GUESTS/CABINS

12/5



NUMBER OF CREW

13



SHIPYARD

AMELS



YEAR BUILT

2016



WEEKLY CHARTER RATE

From 275,000€

ELIXIR

GENERAL ARRANGEMENT

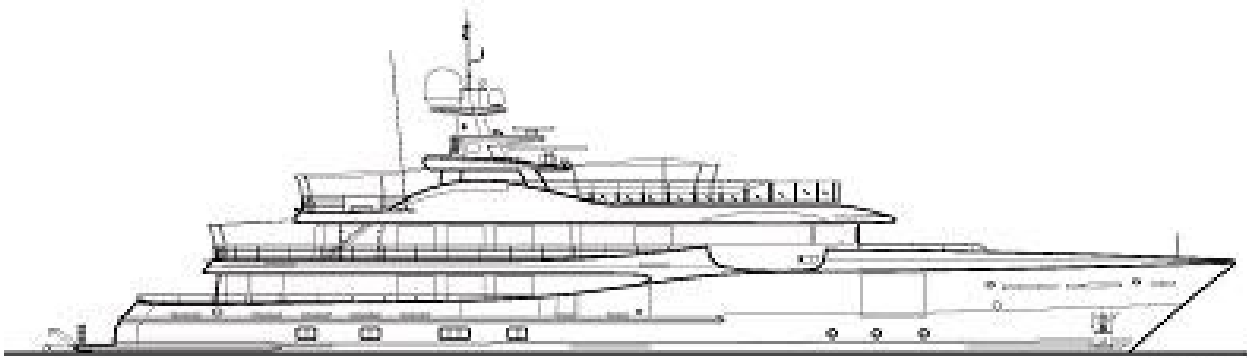

PROFILE

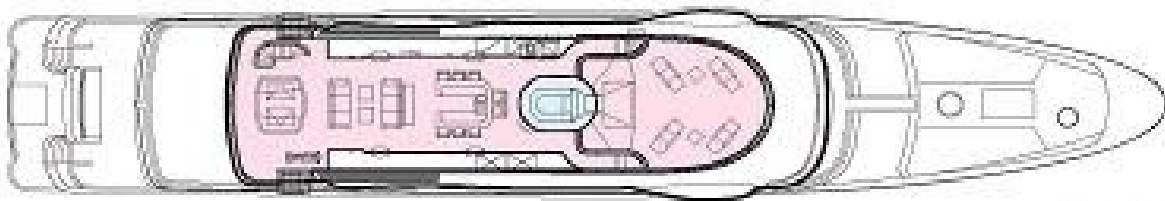

SUN DECK



BRIDGE DECK

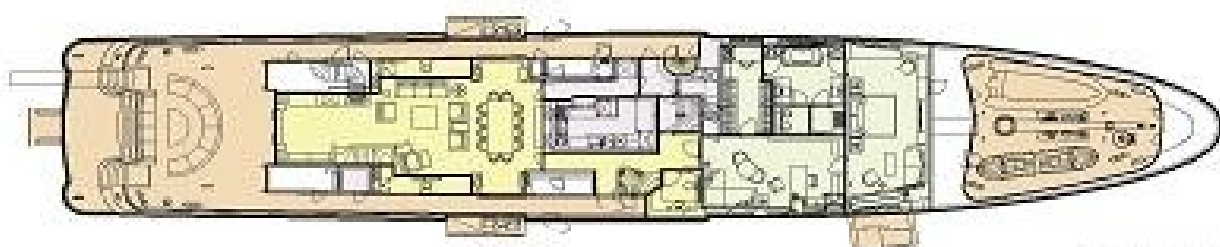

MAIN DECK

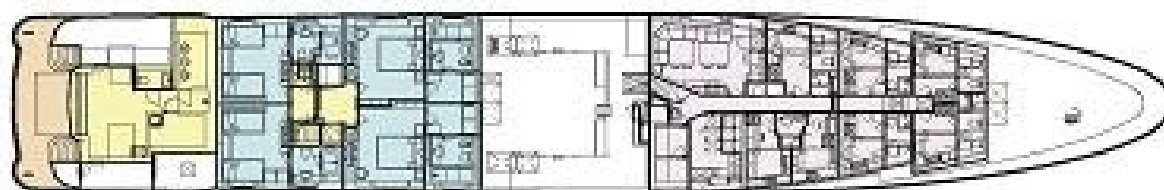

LOWER DECK

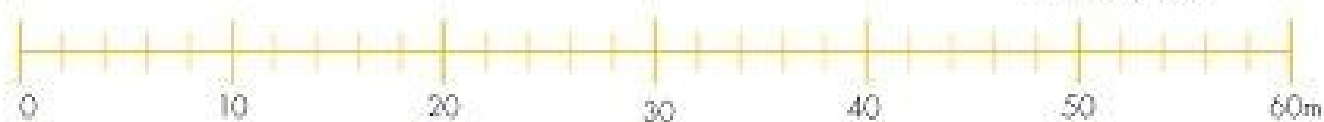

KEY

- | | |
|--|--|
|  DECK |  SUN DECK |
|  GUEST AREAS |  GUEST CABINS |
|  MASTER CABIN |  CREW AREAS |













































FIND US

45 rue Grimaldi

98000 Monaco

Info@dynamiqbrokerage.com

© 2025 DYNAMIQ YACHTS, SARL. All rights reserved.