



# M/Y GIAOLA – LU

Built in steel and aluminium by Turkish yard Bilgin Yachts to a design by H2 Yacht Design, she was delivered in 2016.

Accommodation on Giaola Lu is for up to 12 guests, with a master suite, VIP cabin and four lower deck guest cabins. The full beam master suite has his and hers bathrooms, a walk-in closet and an office, and all guest cabins have en suite bathroom facilities.

Large saloons can be found on the main deck and bridge deck with plenty of space for dining or lounging on the aft decks. The most distinctive feature is her network infrastructure, which allows the owner to control the Harman Kardon sound system, curtains, music, climate control, lighting, televisions and cameras via a mobile phone app.

Her expansive sun deck is extremely versatile, with a hot tub, sun loungers, sofas, a dining table and a bar providing guests with a host of different options. Another seating and sunbathing area can be found forward of the bridge, where there is also storage space for two jet skis.

Two tenders are stored in the superyacht tender garage, with side opening gull wing doors for launching, while another door opens at the transom to open up the beach club and create a large swim platform.

Powered by a pair of 1,450hp CAT C32 diesel engines, she reaches a top speed of 16 knots.



LENGTH

46.8m



BEAM

9.2m



DRAFT

2.45m



MAX SPEED

16kn



MAIN ENGINES

2x Caterpillar C32,  
1081, kW



GUESTS/CABINS

12/6



NUMBER OF CREW

10



SHIPYARD

Bilgin Yachts



YEAR BUILT

2016



PRICE

On Request

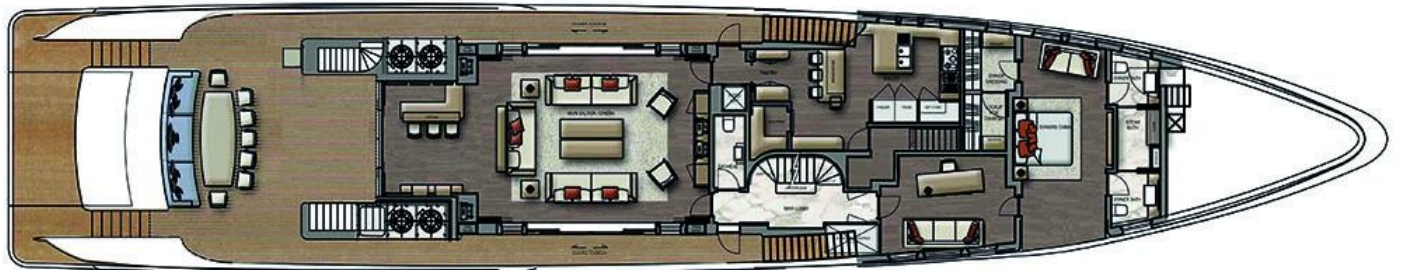
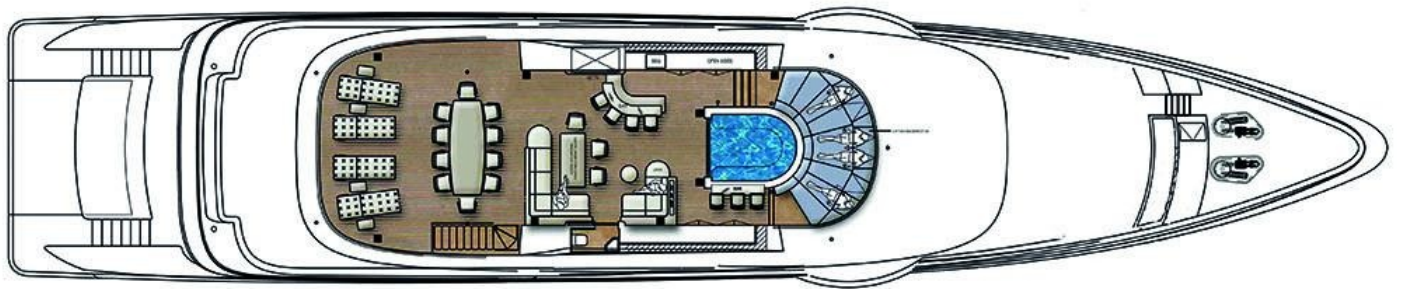
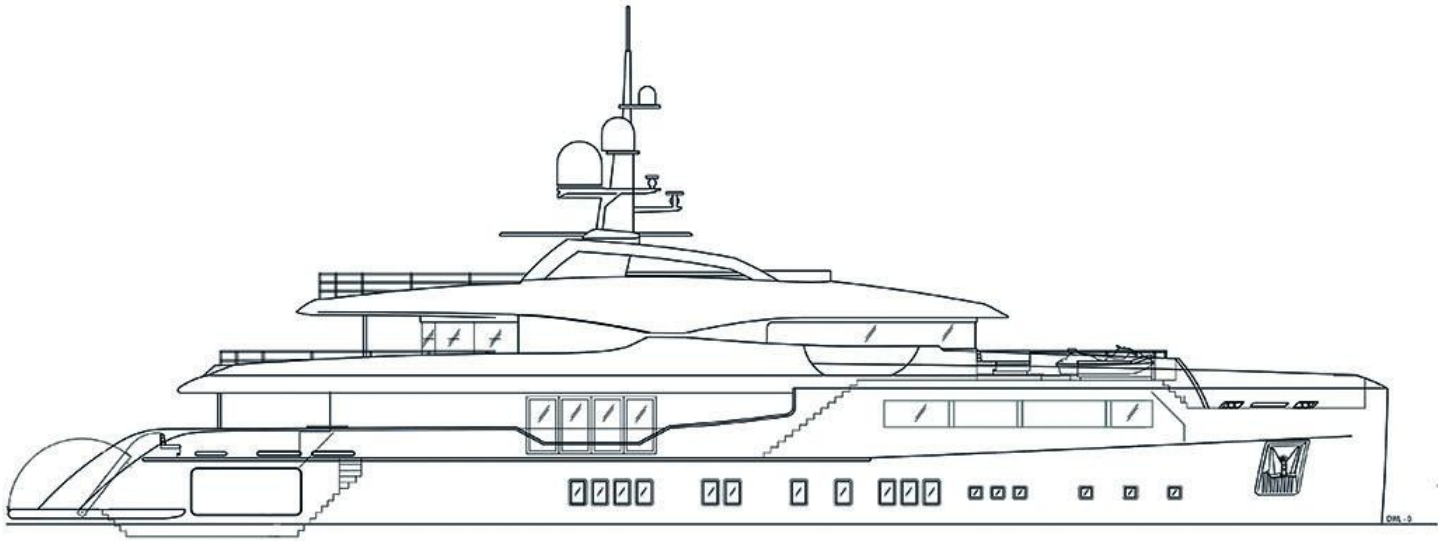



























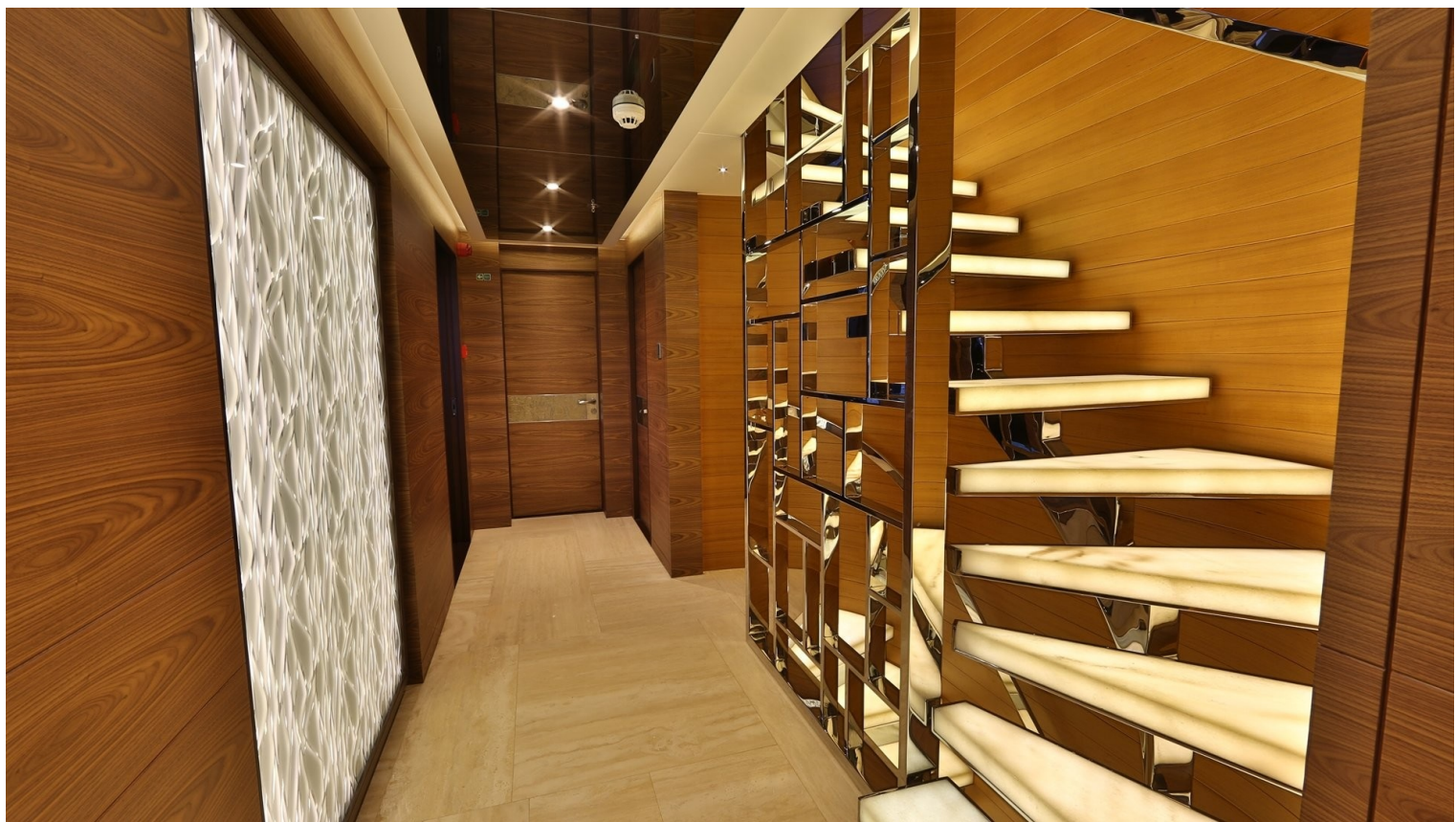









#### FIND US

45 rue Grimaldi  
98000 Monaco

[Info@dynamiqbrokerage.com](mailto:Info@dynamiqbrokerage.com)

© 2025 DYNAMIQ YACHTS, SARL. All rights reserved.