



# M/Y CHECKMATE

Checkmate is one of the well-revered 145-foot (44m) Benetti Visions with delivery in 2013. The yacht's interior was designed by Zuretti and her exterior styling is by Stefano Righini. Checkmate can comfortably accommodate up to 12 guests in 5 cabins with 9 members of crew for satisfying their needs at all times. Her maximum speed is 16kn with power coming from two CAT 970kW engines, the cruising speed is 14kn. Since her delivery in 2013, Checkmate has had an extensive refit in 2018. Checkmate's impressive leisure and entertainment facilities make her the ideal yacht for socializing with family and friends.



LENGTH

44m



BEAM

9.22m



DRAFT

2.59m



MAX SPEED

16kn



MAIN ENGINES

2 x CAT, 956 kW



GUESTS/CABINS

12/5



NUMBER OF CREW

10



SHIPYARD

Benetti



YEAR BUILT

2013/2018



PRICE

10,500,000€

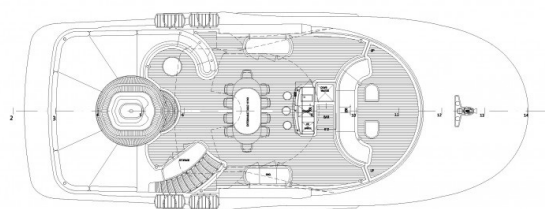
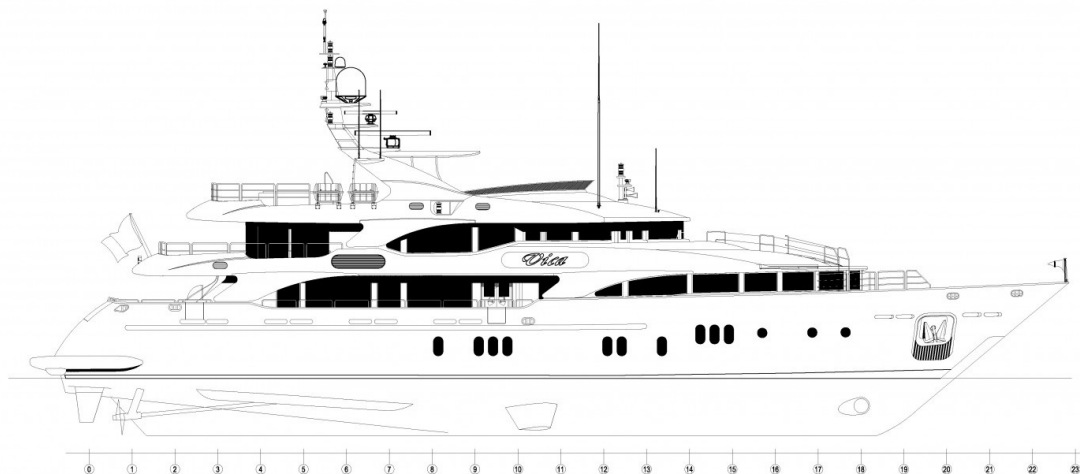

SUN DECK

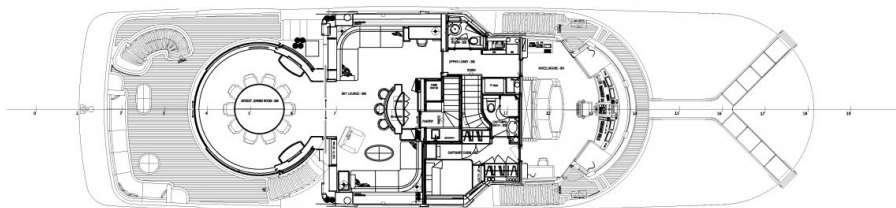

UPPER DECK

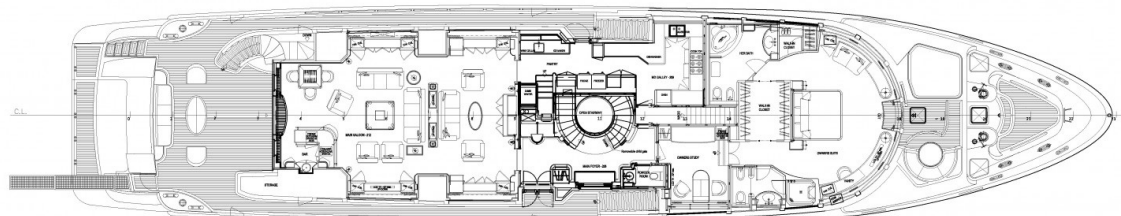

MAIN DECK

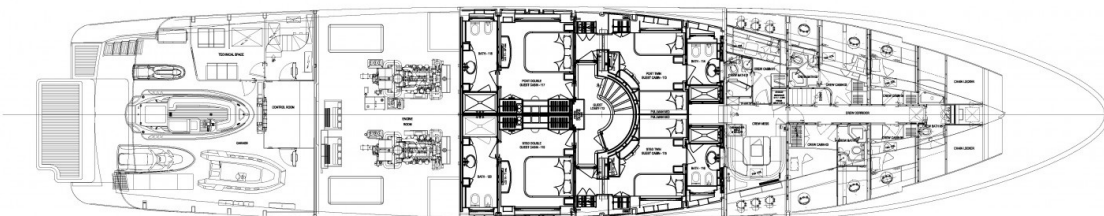

LOWER DECK

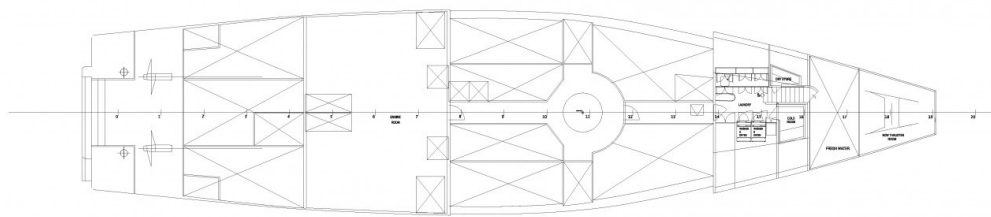

UNDER LOWER DECK

[illegible]

































## FIND US

16 Quai Jean-Charles Rey, 98000 Monaco

+377 9770 8388

[Info@dynamiqbrokerage.com](mailto:Info@dynamiqbrokerage.com)

© 2021 DYNAMIQ YACHTS, SARL. All rights reserved.