



M/Y MAYBE

MAYBE is a 59m superyacht built by the Spanish shipyard Metalships. She was delivered in 2016 with both naval architecture and exterior design done by Acubens while the interior was created by Marcelo Penna. She can sleep up to 12 guests in 6 luxurious staterooms with accommodation by 16 members of crew. Her top speed is 17 kn, powered by 2x1450 kW CAT engines. MAYBE has only had light use since her delivery to her owner which is ideal, overall this yacht is perfect for spending time with family and friends.



LENGTH

59m



BEAM

10.7m



DRAFT

3.1m



MAX SPEED

17kn



MAIN ENGINES

2 x CAT 1450kW



GUESTS/CABINS

12/6



NUMBER OF CREW

16



SHIPYARD

Metalships



YEAR BUILT

2016



PRICE

29,000,000€

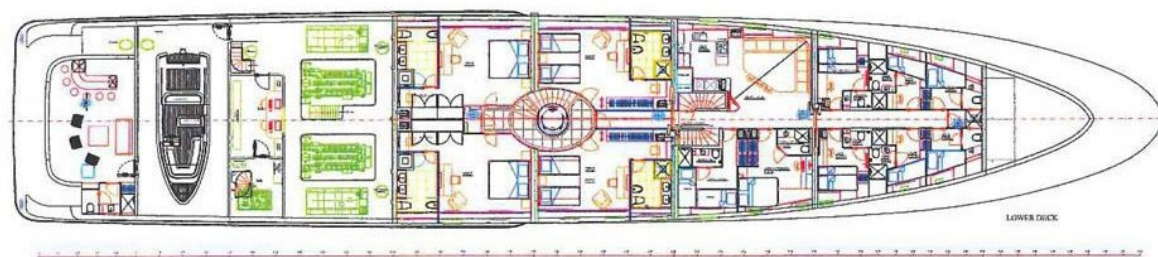
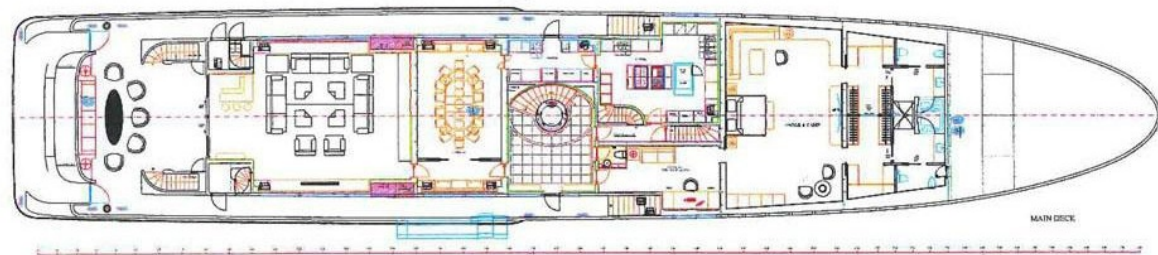
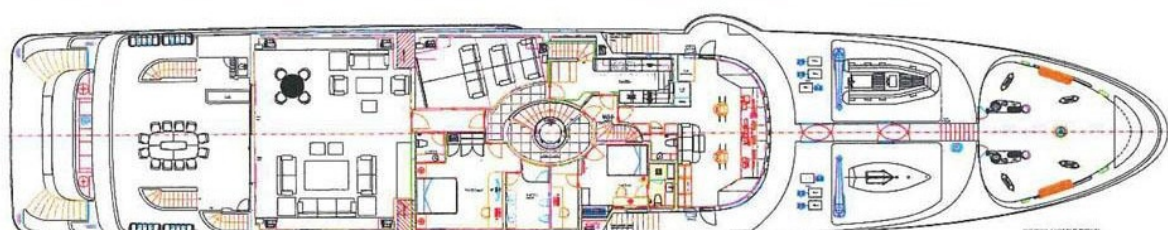
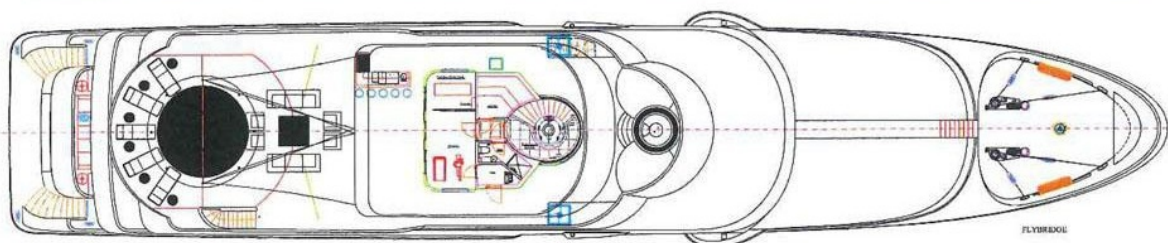























FIND US

45 rue Grimaldi
98000 Monaco

Info@dynamiqbrokerage.com

© 2025 DYNAMIQ YACHTS, SARL. All rights reserved.