



D Y N A M I Q

GRAN TURISMO SERIES

GTM 90

SPORTFISHER

GTM 90
SPORTFISHER

CAPABLE & VERSATILE: THE NEW-WAVE SPORTFISHER

With its ultra-modern look, the GTM 90 Sportfisher features everything you need for game fishing: live bait wells, rod holders, fish freezer storages, tuna tubes and a great fighting chair. The stern has plenty of deck space, an open-type galley and exciting alfresco dining area for sushi-sashimi straight after fishing. A vast flybridge is equipped with a lounging area and pilot station, ideal for spotting tuna schools from a distance. One of the rare sportfishers built entirely from aluminium, the GTM 90 is capable of handling the roughest of conditions, whether it be fishing around oil rigs in the Gulf of Mexico, trolling drop-offs in the North West Pacific, or searching for halibut in the frigid fjords of Scandinavia. Its 30-knot top speed combined with 900 nm range makes it not only a great fishing boat, but also as a superb family yacht.

Designed by Van Oossanen in the Netherlands, the GTM 90 Sportfisher will keep you safe, protected and comfortable everywhere you go.



GTM 90
SPORTFISHER



KEY FEATURES

GTM 90
SPORTFISHER



Hard chine hull shape

Drawn by the famous Dutch naval architects Van Oossanen, the GTM 90 Sportfisher unique hull features a hard chine shape for remarkably low resistance and low fuel consumption, while still being capable of high speeds. To keep spray levels low, an integrated spray rail deflects water hitting the bow area. Built entirely from marine grade aluminium, the GTM 90 Sportfisher hull guarantees unparalleled comfort and safe operation for more than 25 years.



Robust full aluminium construction

Certified marine-grade 5083 aluminium and stronger 5383 Sealium, a lightweight alloy that weighs three times less than steel, is used for Dynamiq GTM 90 Sportfisher hull and superstructure. A lighter hull provides a better performance, shallower draft, lower fuel consumption. Another benefit is that aluminium guarantees a stiff, robust and vibration-free vessel that is very comfortable and behaves well in a heavy swell or choppy seas. The strength-to-weight ratio of aluminium is equivalent to that of steel and there is much less risk of serious damage in case of a collision than with a fibreglass hull. Unlike composite materials, aluminium is fully recyclable, odourless, does not rust or creak at sea and does not burn in the atmosphere.



Curved fin stabilizers by Side Power

Vector Fins stabilisers dramatically reduce roll as well as undesired yaw and sway motions caused by active fins. Their vertical concave shape creates a net force direction, both in cruising and at-anchor modes, so the work is more up-down instead of side-to-side. By changing the net force angle, this also increases the leverage arm around the boat's rolling point, further increasing the physical forces that work on the boat to reduce roll. This provides more efficient stabilisation per fin size, which means that drag and power consumption are a lot less than with other fins offering comparable roll reduction.



XIR glass

The GTM 90 Sportfisher features next-generation laminated XIR glass that allows maximum light transmission, while keeping solar heat gain at bay. Harmful UV rays are almost completely blocked, and heat transmission reduced by 60%. The result is an interior that offers the wide panoramas of large windows without the penalty of heat build-up. This means significantly reduced air-conditioning loads and therefore lower running costs. The glass manufacturer is Isoclima, an Italian high-tech company that also supplies glass for luxury automobiles such as Bentley, McLaren, Mercedes and BMW.



GTM 90
SPORTFISHER



MAIN SPEC

GTM 90
SPORTFISHER

Interior deck heights

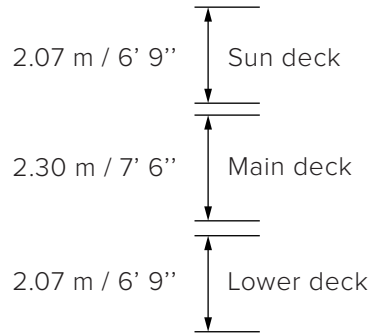

Length overall:	27.5 m / 100'
Beam:	6.7 m / 21'11"
Draft:	1.75 m / 5' 9"
Tonnage:	150 GT
Material:	Full aluminium, 5083
Hull type:	Hard chine

Main engines:	3x Volvo Penta D13 IPS 1350, 533 kW
Generators:	2x 28 kW Kohler
Stabilisers:	2x Side Power curved fins Humphree interceptors + Seakeeper 26 (option)

Max speed:	31 knots
Range:	900 nm @ 15 knots 730 nm @ 20 knots

Fuel:	9,400 l / 2,480 US gallons
Fresh Water:	2,050 l / 541 US gallons
Grey and Black:	1,250 l / 330 US gallons

Guests:	8 in 4 cabins
Crew:	4 in 2 cabins

Tender	Williams 395 (3,9 m / 12' 10")
--------	--------------------------------

Class:	ISO Class A, MCA MGN 280
--------	--------------------------

Naval architecture:	Van Oossanen
Exterior design:	Dobroserdov Design
Interior design:	Giuseppina Arena / Dynamiq



DECK PLANS

GTM 90
SPORTFISHER

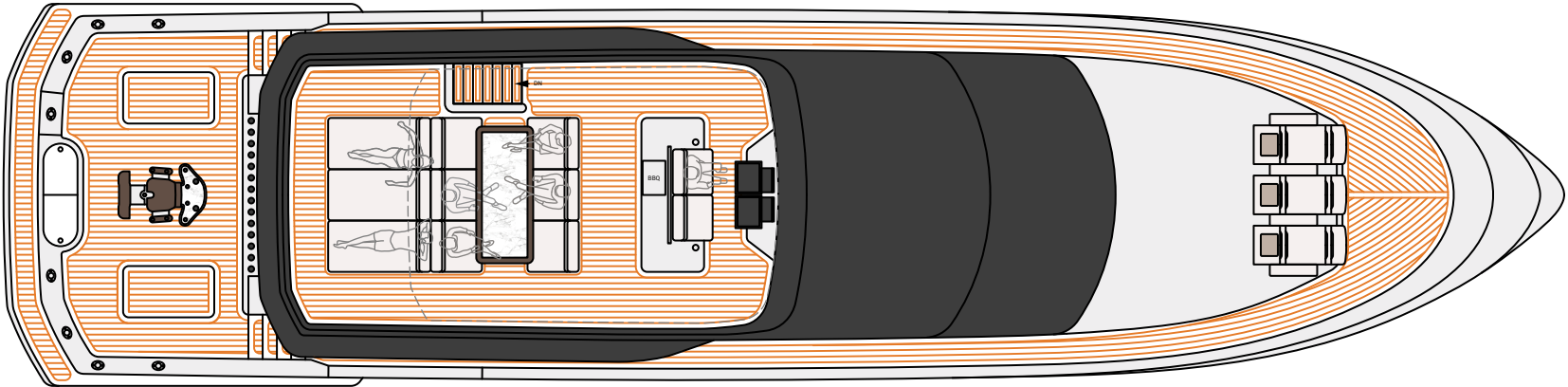
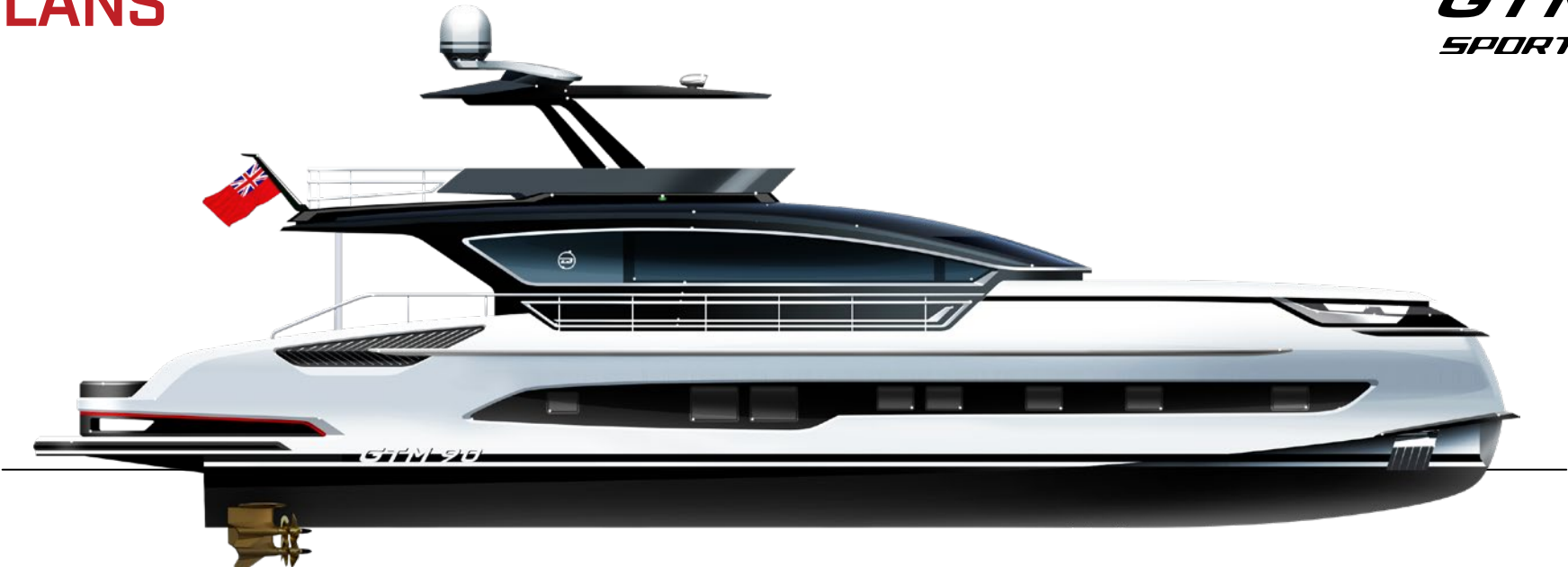

This drawing is the property of Dynamiq Yachts SARL and is not to be modified, used or reproduced in whole or part without written permission.



DECK PLANS

GTM 90 SPORTFISHER

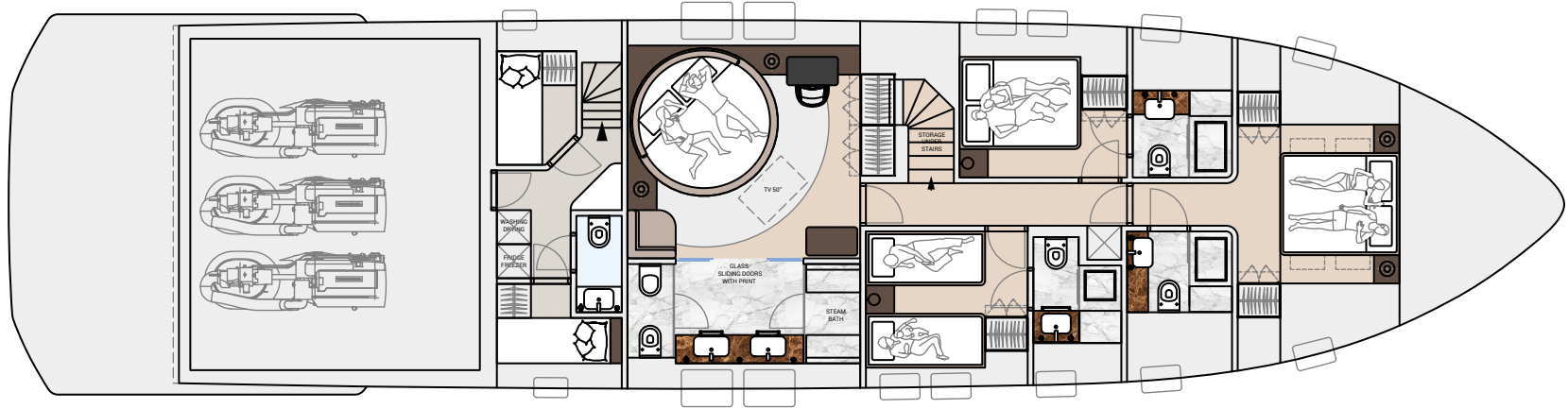
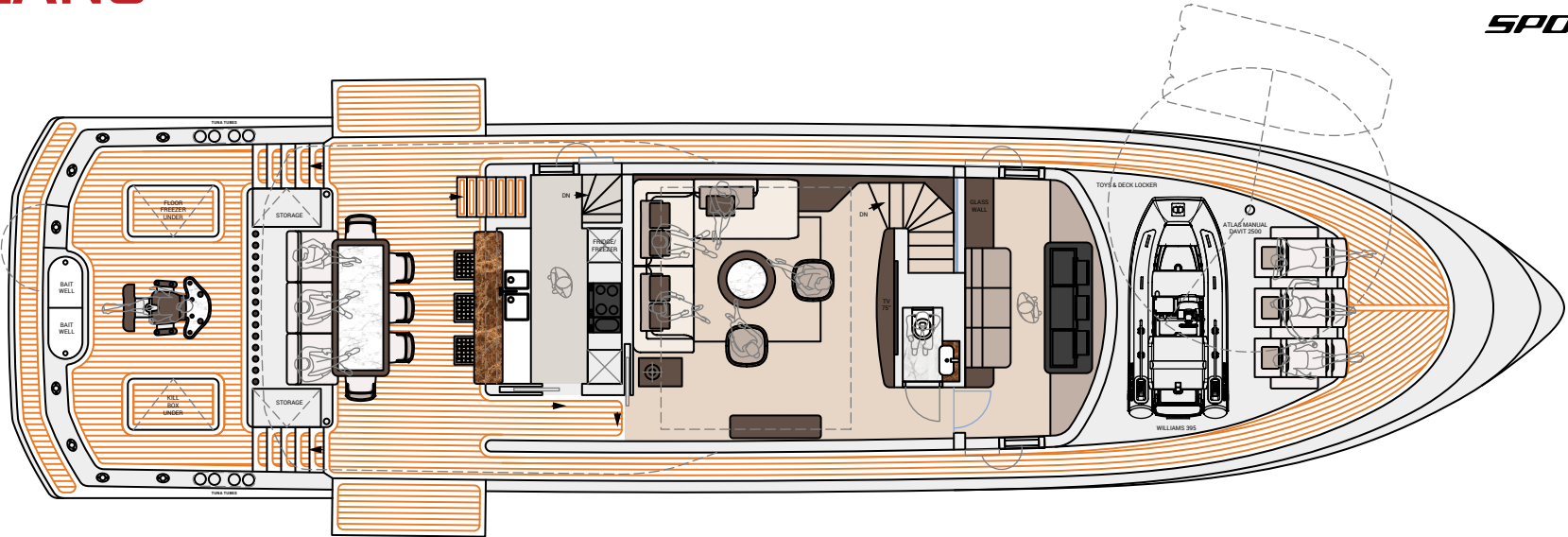

This drawing is the property of Dynamiq Yachts SARL and is not to be modified, used or reproduced in whole or part without written permission.



GTM 90
SPORTFISHER



GTM 90
SPORTFISHER



GTM 90
SPORTFISHER



GTM 90
SPORTFISHER



GTM 90
SPORTFISHER



GTM 90
SPORTFISHER



GTM 90



PRICE, OPTIONS & PAYMENT TERMS

GTM 90
SPORTFISHER

BASE PRICE:

€ 7,100,000

OPTIONS*:

<input type="checkbox"/>	Sport package (metallic paint / carbon trim)	€ 175,000
<input type="checkbox"/>	Silent package	€ 115,000
<input type="checkbox"/>	“Stabilisation +” package	€ 173,000
<input type="checkbox"/>	Bowers & Wilkins package	€ 39,000
<input type="checkbox"/>	Bentley Home interior package	€ 270,000
<input type="checkbox"/>	Heated bathroom floors	€ 17,500
<input type="checkbox"/>	Fine marbles in luxury areas	€ 49,000
<input type="checkbox"/>	Bed linen, bath and deck towels by Frette	€ 45,000
<input type="checkbox"/>	Interior scent diffusion	€ 4,500
<input type="checkbox"/>	Crew call buttons	€ 8,000
<input type="checkbox"/>	Ice dispenser	€ 2,500
<input type="checkbox"/>	2 x Miele wine coolers	€ 9,000
<input type="checkbox"/>	Forward seats on main deck	€ 9,100
<input type="checkbox"/>	Panasonic bow camera	€ 4,500
<input type="checkbox"/>	7 Underwater lights	€ 17,500
<input type="checkbox"/>	VSAT Intellian V60	€ 35,000
<input type="checkbox"/>	V Class by Klassen	€ 195,000
<input type="checkbox"/>	Fun Air inflatable pool	€ 28,000

PAYMENT TERMS:

1st year

Contract signature	20%
Keel laying	20%
Main engines at the yard	25%

2nd year

Interior installation start	20%
Launch	10%
Delivery	5%

BUILD TIME:

18 months

* More options are available at bedynamiq.com





Carrara White Metallic

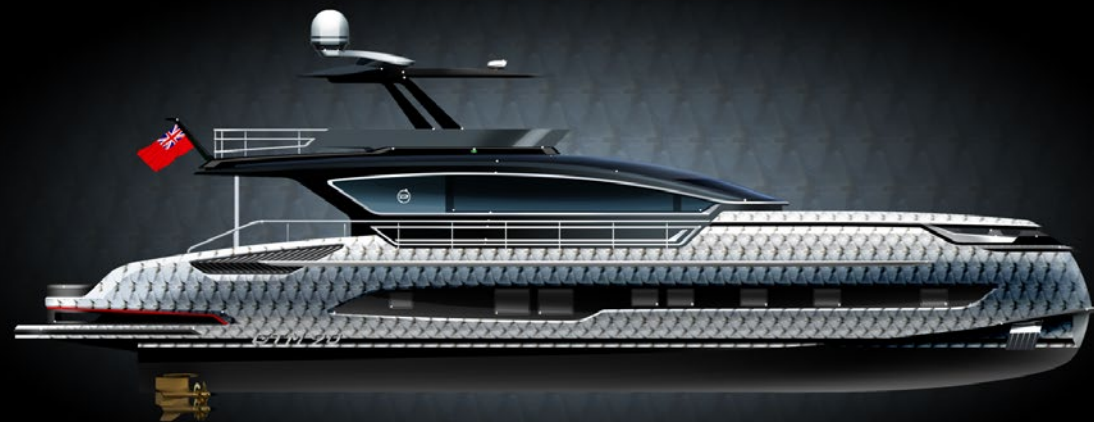

Fish Scales Metallic

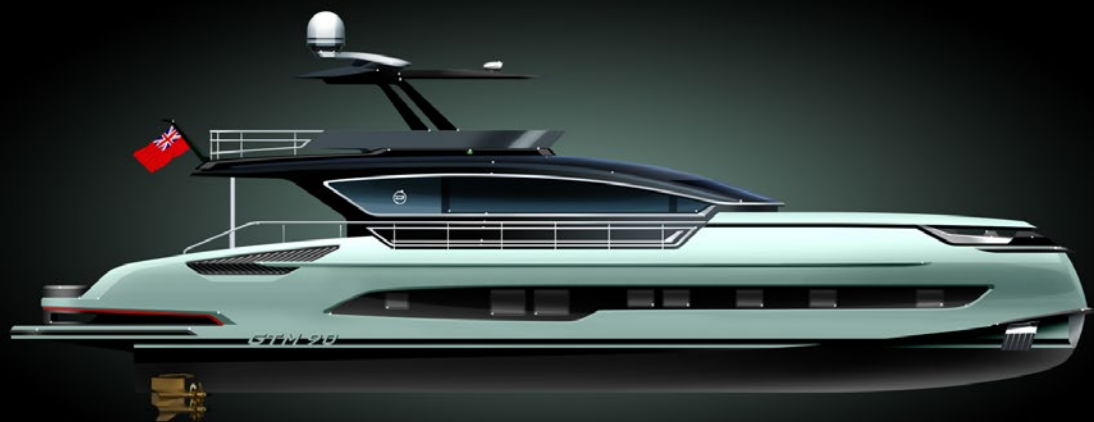

Island Green Metallic



Miami Blue Metallic

THE SHIPYARD

Dynamiq is a private shipyard founded in 2014 and owned by yacht broker and designer Sergei Dobroserdov. His main strategy with Dynamiq was to create a well-organised and owner/broker-friendly facility where clients and their reps can enjoy a creative and transparent construction process.

Dynamiq is the only shipyard in Italy building yachts to North European standards that are 100% created by leading naval architects and structural or mechanical engineering companies in the Netherlands. Dynamiq production is located in the picturesque area of Massa on Italy's Tuscan coast. This modern and high-tech facility is fitted out for building the full range of Dynamiq superyachts up to 50 metres in length with various powertrain options, including hybrid technology. The Dynamiq Yachts production facility offers the highest standards of working environment and quality control.

Come to Dynamiq if you want:

1. Original contemporary design;
2. Top-quality full-aluminum construction;
3. Complete Dutch engineering with naval architecture by Van Oossanen;
4. Top-class contractors and leading brand partners from interior design to high-end audio-visual;
5. Competitive Italian prices.



DYNAMIQ RANGE

THE GRAN TURISMO MEDITERRANEO SERIES



THE GLOBAL SERIES

Model	GTM 90	GTM 90 Sportfisher	G 300	G 350	G 440
LOA	27,5 m / 90'	27,5 m / 90'	30.5 m / 100'	35 m / 114'	44 m / 144'
Beam	6.7 m / 21' 11"	6.7 m / 21' 11"	7.5 m / 24' 7"	8.5 m / 27' 10"	9.2 m / 30' 2"
Draft	1.75 m / 5' 9"	1.75 m / 5' 9"	1.45 m / 4' 9"	1.8 m / 5' 3"	2 m / 6' 6"
Max speed	31 knots	31 knots	19 knots	16 knots	17 knots
Range	900 nm @ 15 knots	900 nm @ 15 knots	3,000 nm @ 10 knots	3,100 nm @ 10 knots	5,000 nm @ 10 knots
Engines	3x Volvo Penta, 735 kW	3x Volvo Penta, 735 kW	2x MAN, 882 kW	2x MAN, 882 kW	2x MAN, 882 kW
Hull / superstructure	Aluminium, 5083	Aluminium, 5083	Aluminium, 5083	Aluminium, 5083	Aluminium, 5083
Tonnage	150 GT	150 GT	200 GT	299 GT	499 GT
Guests	8 in 4 cabins	8 in 4 cabins	10 in 4 cabins	10 in 5 cabins	10 in 5 cabins
Crew	4 in 2 cabins	4 in 2 cabins	4 in 2 cabins	6 in 3 cabins	7 in 4 cabins
Build time	18 months	18 months	22 months	22 months	28 months
Price	starting at 7,500,000 €	starting at 7,100,000 €	starting at 9,400,000 €	starting at 16,450,000 €	starting at 23,500,000 €



DYNAMIQ RANGE

THE GRAN TURISMO TRANSATLANTIC SERIES



Model	GTT 115	GTT 135	GTT 160	GTT 165
LOA	35.5 m / 115'	41 m / 135'	49.5 m / 162'	50 m / 165'
Beam	7.1 m / 23' 3"	8.2 m / 26' 11"	8.7 m / 28' 6"	8.5 m / 27' 10"
Draft	1.45 m / 4' 9"	1.8 m / 5' 11"	2 m / 6' 6"	2 m / 6' 6"
Max speed	21 knots	21 knots	17 knots	20 knots
Range	3,400 nm @ 10 knots	3,000 nm @ 12 knots	4,000 nm @ 10 knots	4,000 nm @ 12 knots
Engines	2x MAN, 1,213 kW	2x MAN, 1,213 kW	2x MAN i6, 537 kW	2x MTU 8V, 932 kW
Hull / superstructure	Aluminium, 5083	Aluminium, 5083	Aluminium, 5083	Aluminium, 5083
Tonnage	199 GT	299 GT	399 GT	450 GT
Guests	10 in 5 cabins	11 in 5 cabins	12 in 6 cabins	12 in 6 cabins
Crew	6 in 3 cabins	6 in 3 cabins	8 in 4 cabins	9 in 5 cabins
Build time	16 months	16 months	24 months	28 months
Price	starting at 11,500,000 €	starting at 16,500,000 €	starting at 19,900,000 €	starting at 24,750,000 €





LIVE SMART. BE DYNAMIQ.



Via Massa Avenza 85, 54100 Massa, Italy

www.bedynamiq.com

 @bedynamiq