



M/Y HELIOS 2

The interior has been designed by Ramsey Engler, Sparkman & Stephens and has exterior styling by Sparkman & Stephens. HELIOS 2 is blending modern and classic styles. She is featured by large sun deck, covered in part by a fixed hard top for shade, has a spa pool forward surrounded by sun beds. Accommodation is for up to 12 guests in 5 cabins including a full beam master suite on the main deck.



ДЛИНА

51m



ШИРИНА

8.64m



ОСАДКА

2.59m



МАКСИМАЛЬНАЯ СКОРОСТЬ

15kn



ГОСТЕЙ/КАЮТ

12/5

КОЛИЧЕСТВО ЧЛЕНОВ
ЭКИПАЖА

12



ВЕРФЬ

PALMER
JOHNSON

ГОД ПОСТРОЙКИ

2002/2015



ЦЕНА ЗА НЕДЕЛЮ

От 161,500€

HELIOS²

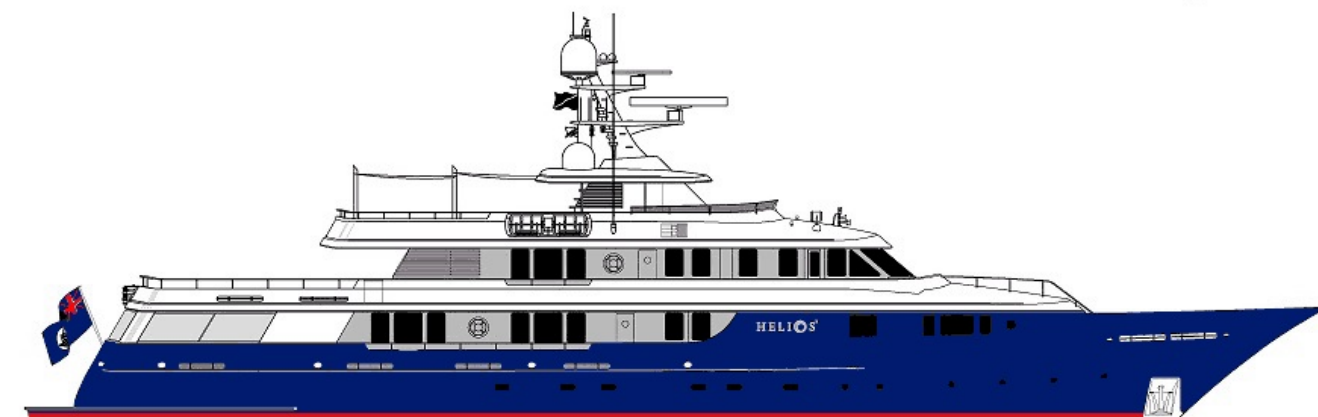

42 41 40 39 38 37 36 35 34 33 32 31 30 29 28 27 26 25 24 23 22 21 20 19 18 17 16 15 14 13 12 11 10 9 8 7 6 5 4 3

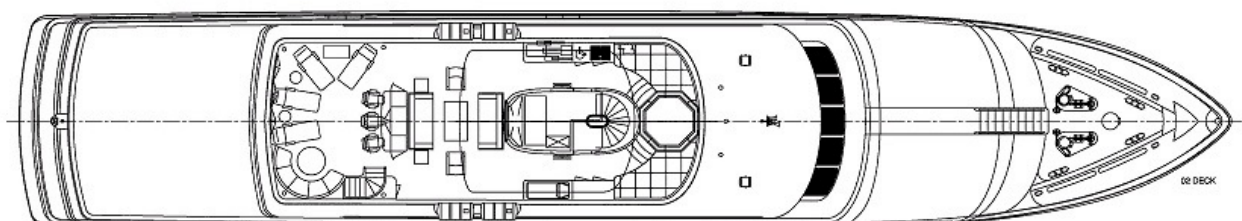

42 41 40 39 38 37 36 35 34 33 32 31 30 29 28 27 26 25 24 23 22 21 20 19 18 17 16 15 14 13 12 11 10 9 8 7 6 5 4 3

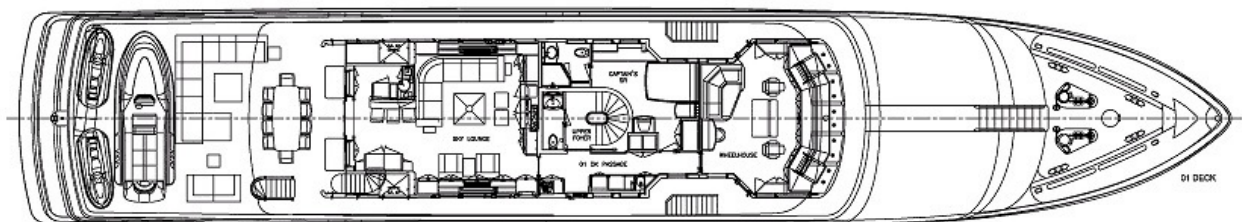

42 41 40 39 38 37 36 35 34 33 32 31 30 29 28 27 26 25 24 23 22 21 20 19 18 17 16 15 14 13 12 11 10 9 8 7 6 5 4 3

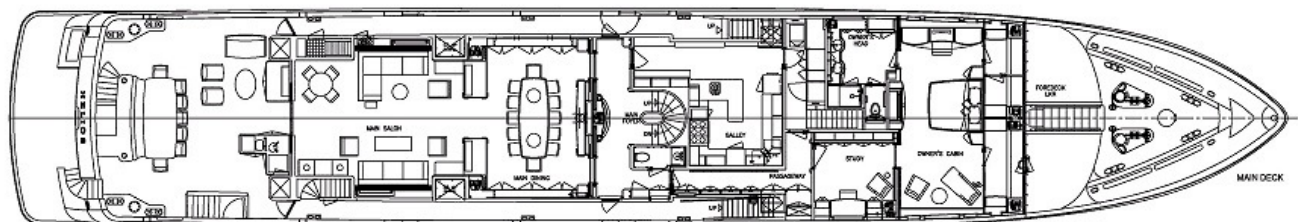

42 41 40 39 38 37 36 35 34 33 32 31 30 29 28 27 26 25 24 23 22 21 20 19 18 17 16 15 14 13 12 11 10 9 8 7 6 5 4 3

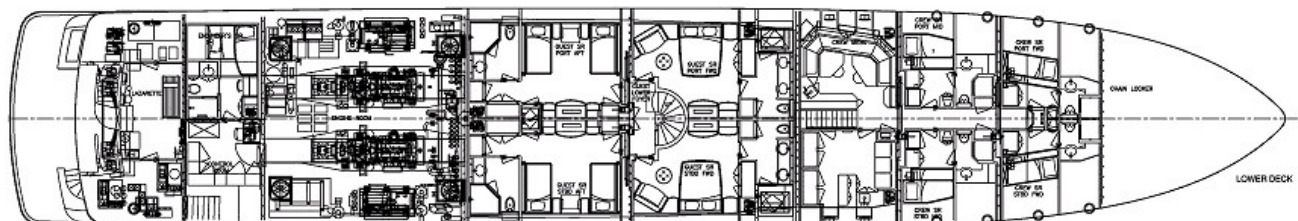

42 41 40 39 38 37 36 35 34 33 32 31 30 29 28 27 26 25 24 23 22 21 20 19 18 17 16 15 14 13 12 11 10 9 8 7 6 5 4 3

MURRAY & ASSOCIATES LLC NAVAL ARCHITECTS MARINE ENGINEERS		4101 Riverwood Road Suite 210 Fort Lauderdale, FL 33312 USA Tel: (954) 521-0500 Fax: (954) 521-0504 Email: info@murrayco.com	
PROJECT:		M352 - HELIOS	
TITLE:		GENERAL ARRANGEMENT	
FORWARDED:	REF. A	DESIGNED BY:	DATE
MY HELIOS	352	M-352-640-007	06/05/06
SCALE:	DATE:	SIZE:	ENGINEER: RD
1:100	06/05/06	24" X 36" (R)	CHAFFETMARE: DC
This drawing created in AutoCAD 2006			

























НАШИ КОНТАКТЫ

45 rue Grimaldi

98000 Monaco

Info@dynamiqbrokerage.com

© 2025 DYNAMIQ YACHTS, SARL. All rights reserved.